

Full metal housing inductive sensors **LR30** series



Features

- ◆ High quality stainless steel housing, effective protection;
- ◆ More reliable, less maintenance cost;
- ◆ Perfect choice for food and chemical industry;



Part number

NPN NO LR30XCN15DNOQ-E2

PNP NO LR30XCN15DPOQ-E2

NPN NC LR30XCN15DNCQ-E2

PNP NC LR30XCN15DPCQ-E2

Technical specifications

Mounting	Non-Flush	Circuit protection	Short-circuit, overload and reverse polarity
Rated distance	15mm	Output indicator	Yellow LED
Assured distance	0...12.15mm	Ambient temperature	-25°C...70°C
Dimensions	M30*74mm	Sensing face material	Stainless steel 316L
Output	NO/NC(depends on part number)	Switching frequency	25 Hz
Supply voltage	10...30 VDC	Voltage withstand	1000V/AC 50/60Hz 60s
Standard target	Fe 45*45*1t	Insulation resistance	≥50MΩ(500VDC)
Switch-point drifts	≤±10%	Vibration resistance	Complex amplitude 1.5mm 10...50Hz (2 hours each in X, Y, and Z directions)
Hysteresis range	1...20%	Degree of protection	IP67
Repeat accuracy	≤5%	Housing material	Stainless steel 361L
Load current	≤200mA	Connection type	M12 connector
Residual voltage	≤2.5V		
Current consumption	≤15mA		

Dimensions

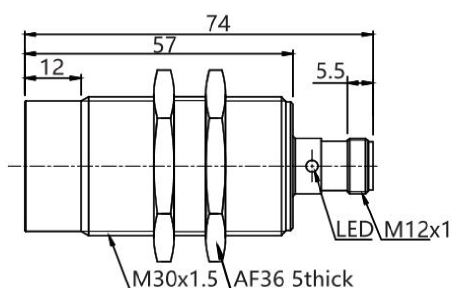

Wiring diagram

